

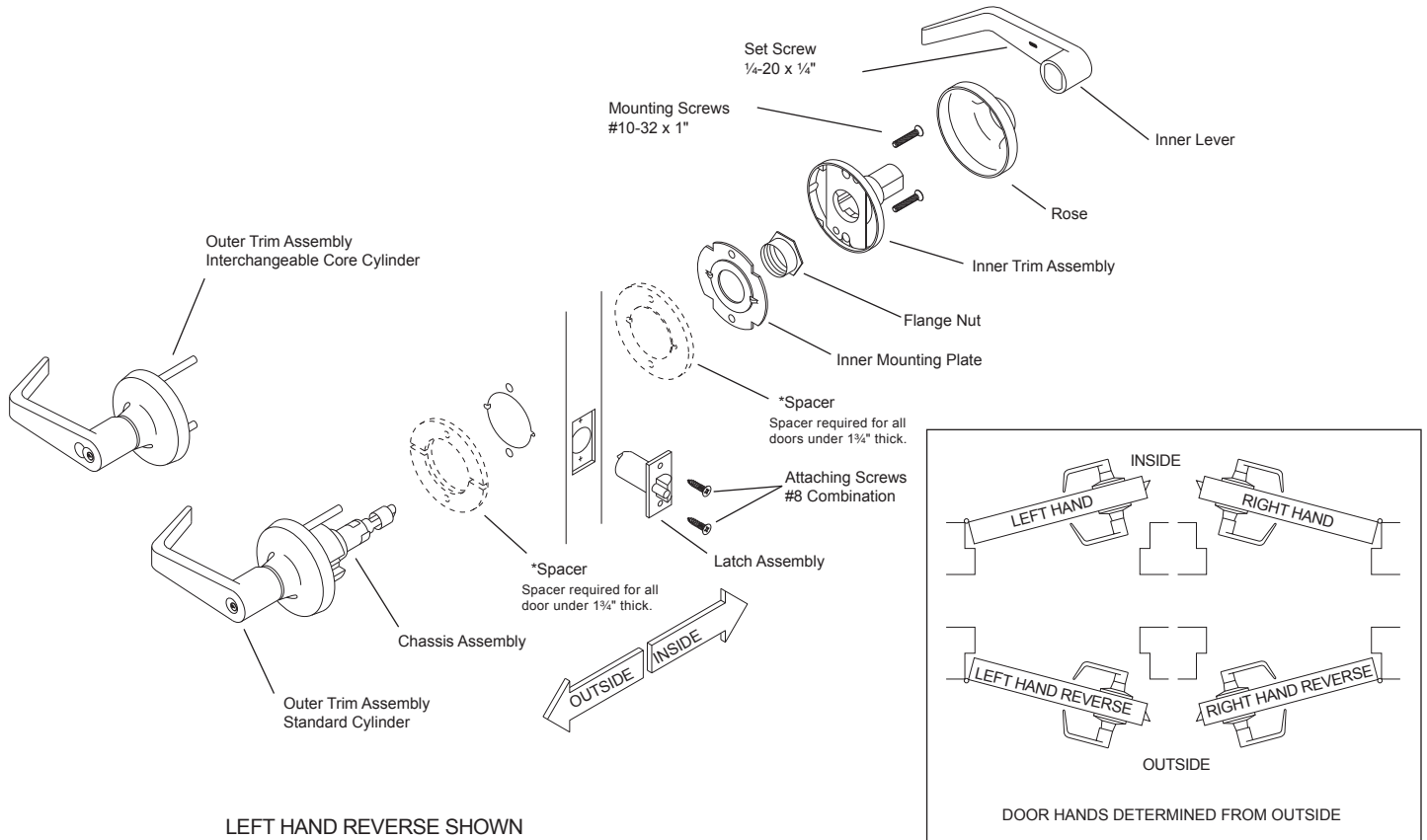

FALCON®

INSTALLATION INSTRUCTIONS FOR INSTALLING T-SERIES EXTRA HEAVY DUTY LEVER LOCKSET

IMPORTANT: THIS LOCK IS NON-HANDED. LOCK IS FACTORY PACKED PREADJUSTED FOR 1 3/4" (45mm) THICK DOORS. TO ADJUST LOCK FOR OTHER DOOR THICKNESS, SEE STEP 8, 9 & 10. SPACERS MUST BE USED FOR DOORS THINNER THAN 1 3/4" (45mm) THICK. FOR FUNCTIONS T341, T351, T371, T381, T391, T561 & T571 SEE STEPS 17 (STANDARD CYLINDER) OR 18 (IC CORE) FOR TIMING INSTRUCTIONS.



STEP 1 MARK DOOR

Fold template on line indicated. Place on **HIGH EDGE** of door bevel. Position centerline of template on heightline (suggested height is 38" (965mm) from floor).

- Locate and mark center for 2 1/8" (54mm) hole.
- Locate and mark positions for notches. **Caution:** Notches must be horizontal.
- Locate and mark center for two (2) 5/16" (8mm) thru-bolt holes.
- Locate and mark center for 1" (25mm) latch bolt hole in door edge.

Note: If steel frames are used, the latch centerline must be in line with the center of the strike preparation.

Hint: For retrofitting of existing 2 1/8" (54mm) holes, fold template in half to locate position for the two (2) 5/16" (8mm) holes.

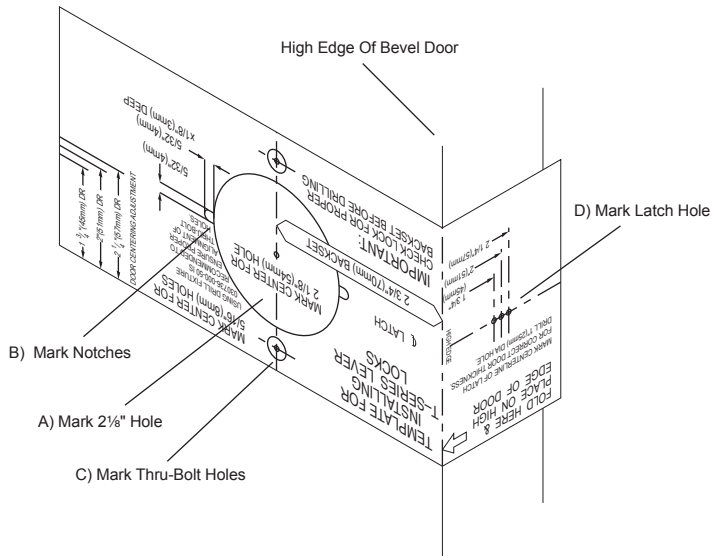

STEP 2 BORE HOLES: INSTALL LATCH

When drilling through door, be careful not to damage door finish.

- Bore a 2 1/8" (54mm) hole and two (2) 5/16" (8mm) holes from both sides of door to avoid splintering wood.
- Bore a 1" (25mm) hole into door edge. Using latch faceplate as pattern, trace outline and mortise door edge so latch is flush with door. If 3/4" projection latch is to be installed see Step 20.

Note: For wood jambs, close door and using a strike-locating tool or other pointed object mark position of hole in jamb. Open door and drill 1" (25mm) hole in jamb minimum 3/4" (19mm) deep.

- File two (2) 5/32" (4mm) x 5/32" (4mm) x 1/8" (3mm) deep notches into both sides of door.
- Insert latch unit in door, making certain that latch bolt bevel faces direction of closing door. Attach with two #8 combination screws provided.

Note: Use of a drill guide is recommended to ensure straight and level holes.

IF USING THE FALCON OPTIONAL DRILL GUIDE

Install Drill Guide (030736-000-70) into door. Make certain correct backset locators are even with door edge. Drill two (2) 5/16" (8mm) holes from both sides to center.

Note: Drill guide replacement is recommended after 10 door preparations.

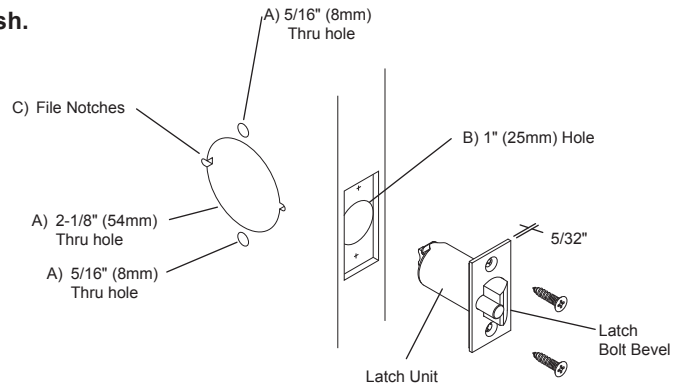

Use faceplate as pattern for mortise.

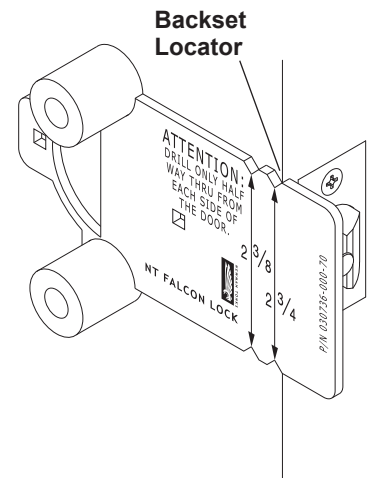

STEP 3 INSTALL CHASSIS AND OUTER TRIM ASSEMBLY

Note: For ease of installation, lock should be in the **unlocked** position.

Slide chassis assembly into door from outside making sure that lock housing engages latch prongs. Retractor must also engage latch tail.

Important: Chassis assembly must be positioned in center of door for proper operation.

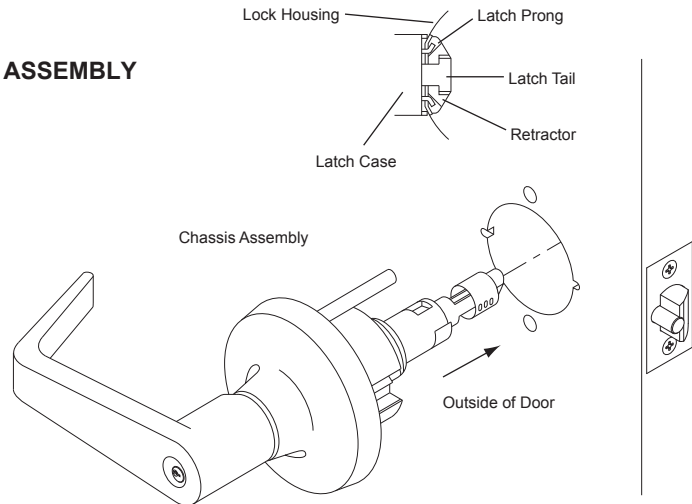

STEP 4 INSTALL INNER MOUNTING PLATE

- Place inner mounting plate onto chassis assembly making sure that plate tabs engage horizontal notches in door.
- Position flanged nut over chassis assembly and tighten securely with hex wrench provided.

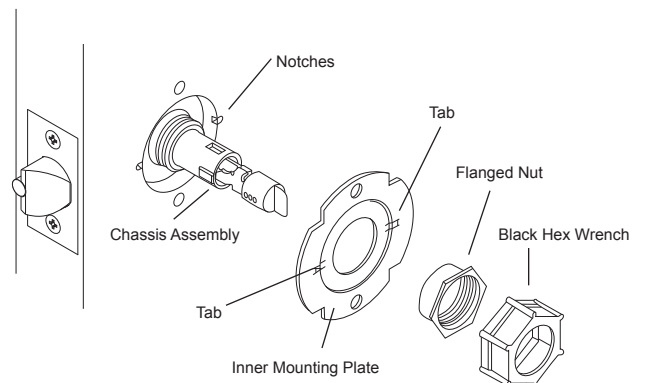

STEP 5 INSTALL INNER TRIM ASSEMBLY

Slide inner trim assembly over chassis spindle. Thru-posts will engage inner trim assembly on 1 $\frac{3}{4}$ " (45mm) thick doors. Secure to door with two #10-32 x 1" machine screws provided.

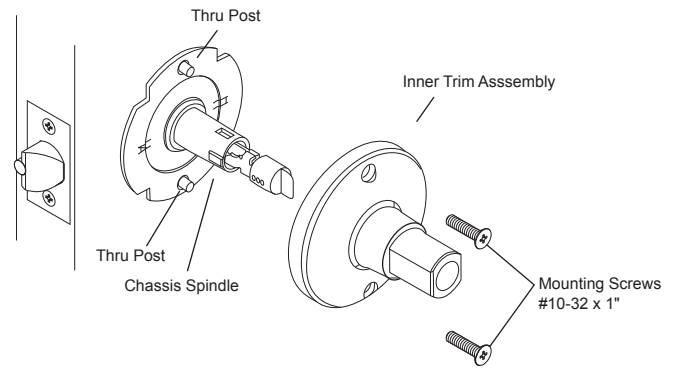

STEP 6 INSTALL INNER LEVER

- Position rose over inner trim assembly making sure rose detent engages groove in spindle assembly.
- Install lever handle and tighten set screw with hex key provided.

Stop! Test operation to be sure latch bolt moves freely. **Do not force.** If lockset does not operate properly, remove lockset from door and check door preparation and door thickness adjustment. See Step 4 to re-install chassis.

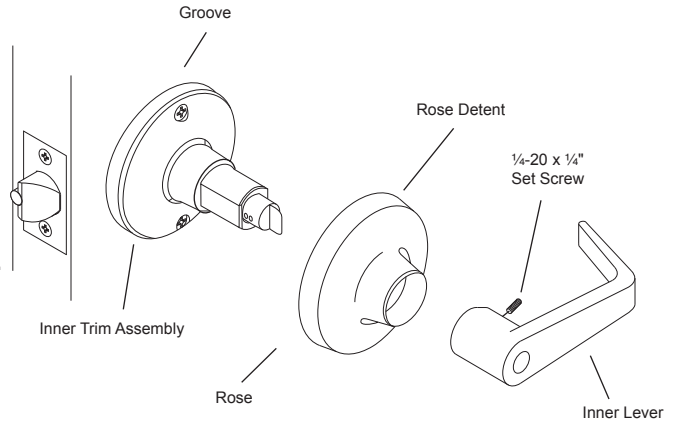

STEP 7 LOCATE AND INSTALL STRIKE

- For wood jambs center strike latch opening over 1" (25mm) hole in jamb. Trace outline around the strike on door jamb.
- Mortise door jamb to accommodate strike box and strike.
- Insert strike box if required and fasten strike to jamb with combination screws provided.

Caution: Deadlocking plunger of latch bolt must not enter opening in strike plate.

Note: When strike box is not used, recess in jamb must be a minimum of $\frac{9}{16}$ " (14mm) deep to allow latch bolt to extend to its full projection.

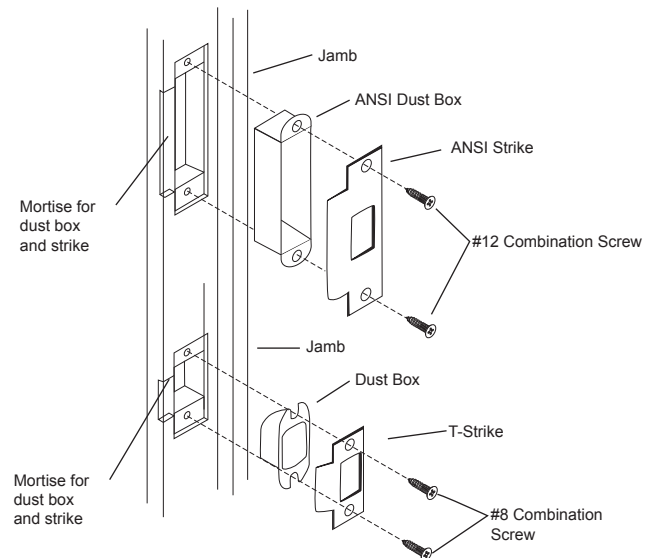

STEP 8 INSTRUCTIONS FOR REMOVING OUTSIDE TRIM

- Remove the outside trim retaining screw (A).
- Slide the outside trim (B) from the chassis assembly.
- See Step 9 for chassis adjustment procedure, or Step 10 for spacer installation.
- Slide the outside trim (B) onto the chassis.
- Replace the outside trim retaining screw (A).

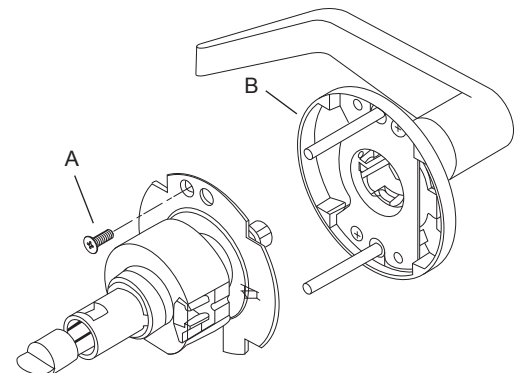

STEP 13 TO REMOVE ALL CYLINDER LEVERS
(Except Interchangeable Core)

- A. Insert key and rotate clockwise approximately 60 degrees.
- B. Depress lever retainer with tool provided.
- C. Slide lever off spindle.

TO RE-INSTALL LEVER

- D. Insert cylinder into spindle.
- E. Slide lever onto spindle.
- F. Insert key into cylinder and rotate clockwise approximately 60 degrees and push lever over retainer.
- G. Pull on lever to be sure retainer engaged lever.

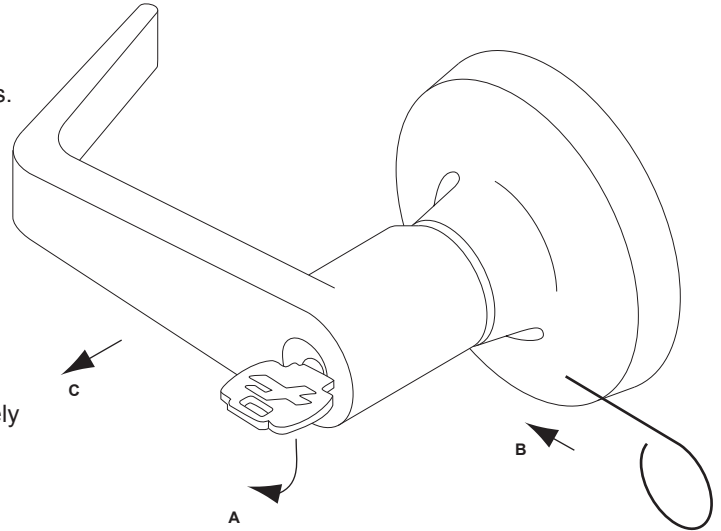

STEP 14 TAILPIECE INSTALLATION

For proper function of the lock the tailpiece must be installed correctly. All T-Series tailpieces should be installed **VERTICALLY** in the cylinder.

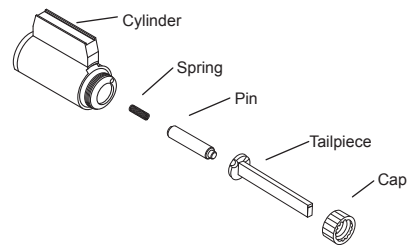

STEP 15 DOUBLE DUMMY TRIM, T18

- A. Using template described in Step 1, locate and mark center for two (2) 5/16" (8mm) Thru-Bolt Holes.
- B. Bore two (2) 5/16" (8 mm) holes from both sides of door to avoid splintering wood.
- C. Holding outer trim against door, position inner spindle assembly over thru-posts and secure to door with two #10-32 x 1" machine screws provided.
- D. See Step 6 for lever installation.

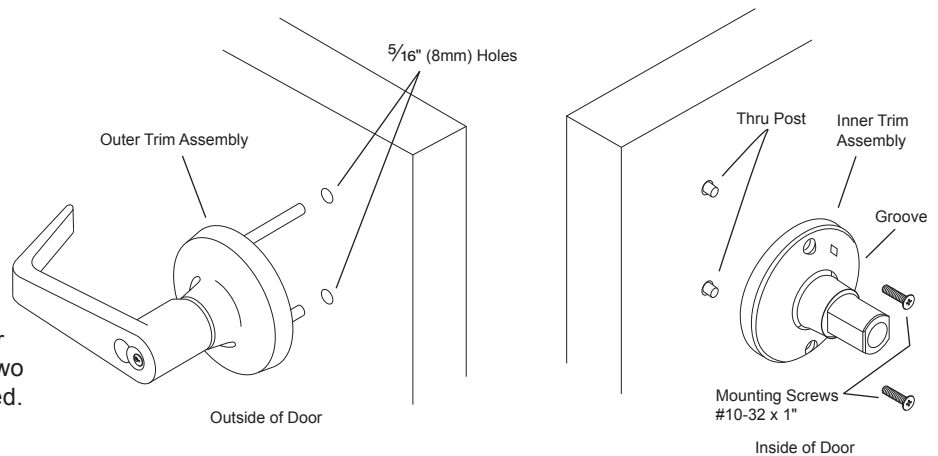

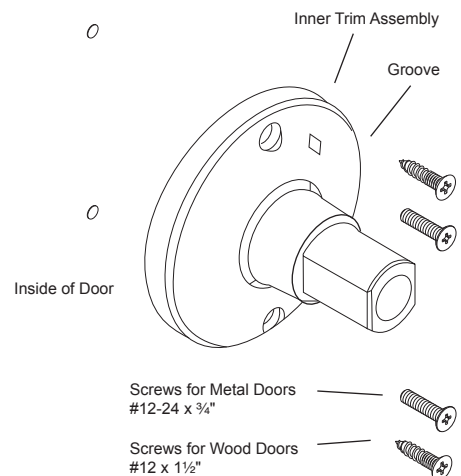

STEP 16 SINGLE DUMMY TRIM, T12

- A. Using template described in Step 1, locate and mark center for two (2) mounting holes.
- B. **For Wood Door** - Drill two (2) pilot holes 5/32" (4mm) x 7/8" (22mm) deep for #12 wood screws.
For Metal Door - Drill and tap two (2) holes for #12-24 machine screws.
- C. Position spindle assembly over mounting holes and secure to door with screws provided.
- D. See Step 6 for lever installation.



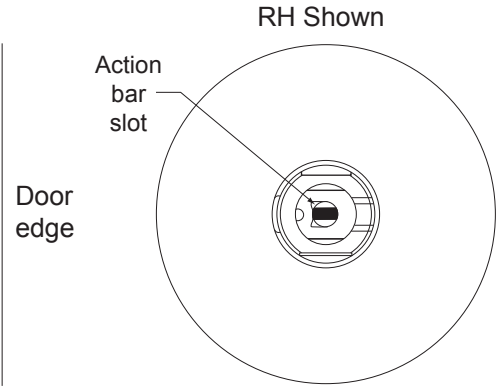

STEP 17 TIMING INSTRUCTIONS FOR STANDARD CYLINDER LOCKS
 FOR THE FOLLOWING FUNCTIONS: T341, T351, T371, T381, T391, T561, T571

- A. If the cylinder and handle are installed, refer to step 13 for lever removal instructions.
- B. Using a thin flat screw driver, turn the action bar slot clockwise (cw) until it stops at about 2:00. 
- C. Then turn the action bar counterclockwise (ccw) to the 9:00 position. **NOTE:** No physical stop is at this location. 
- D. With the key out, install standard cylinder into the spindle.
- E. Refer to step 13 for lever installation instructions.
- F. Operate key to test for proper operation.



STEP 18 TIMING INSTRUCTIONS FOR IC CORE LOCKS
 FOR THE FOLLOWING FUNCTIONS: T341, T351, T371, T381, T391, T561, T571

- A. If the core is installed, refer to step 11 for IC core removal instructions.
- B. Using a thin flat screw driver, turn the action bar slot clockwise (cw) until it stops at about 11:00. 
- C. Then turn the action bar counterclockwise (ccw) to the 7:00 position. **NOTE:** There is NO physical stop is at this location. 
- D. Using the control key, insert IC core into the lever and spindle.
- E. Remove control key.
- F. Operate key to test for proper operation.

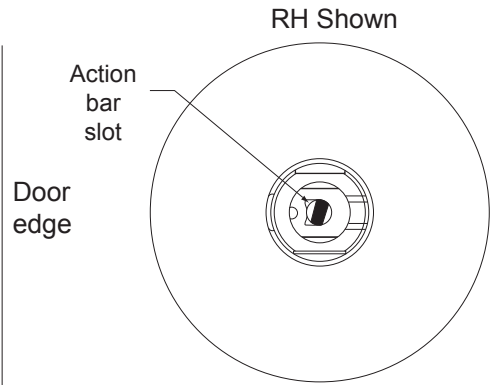

STEP 19 TAILPIECE INSTALLATION INSTRUCTIONS FOR T381 FUNCTION

SEE STEP 14 FOR
 STANDARD CYLINDER
 TAILPIECE
 INSTALLATION

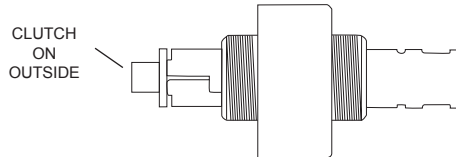
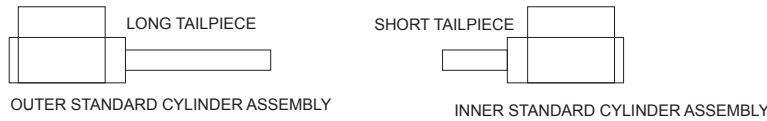

SEE STEP 12 FOR
 IC CORE TAILPIECE
 INSTALLATION

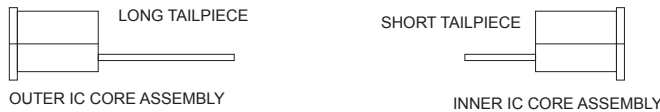

STEP 20 INSTALLATION INSTRUCTIONS FOR OPTIONAL 3/4" PROJECTION LATCH

- A. Determine the hand of the door.
- B. On the side closest to the door stop, remove shaded area as shown. Use a standard rotary file 3/8" diameter maximum.
- C. Try latch for fit and function.
- D. Secure latch with two (2) #8-32 machine screws provided.

